

MS22D17

N NON-SHORTING

Rating: 0.3A 6V DC
 Travel: 2 mm
 Function: 2P2T
 Operating Force: 250 gf ± 150 gf
 Initial Contact Resistance: 70 mΩ MAX

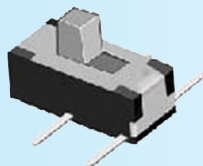
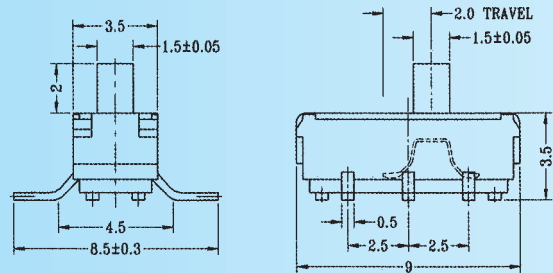
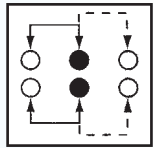

MS22D18

Rating: 0.3A 6V DC
 Travel: 2 mm
 Function: 2P2T
 Operating Force: 250 gf ± 150 gf
 Initial Contact Resistance: 70 mΩ MAX

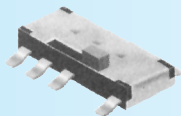
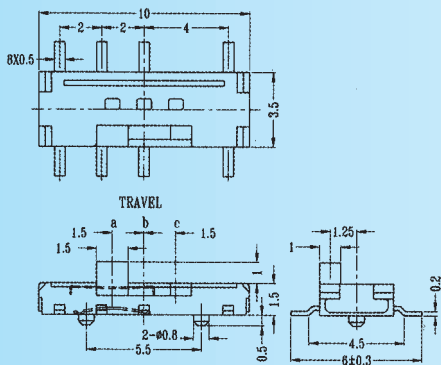
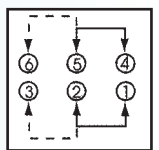

MS23C01

N NON-SHORTING

Rating: 0.3A 4V DC
 Travel: 1.5 mm
 Function: 2P3T
 Operating Force:
 a-b, b-c 200 gf ± 100 gf
 c-b, b-a 250 gf ± 100 gf
 Initial Contact Resistance: 70 mΩ MAX

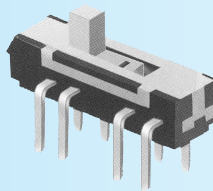
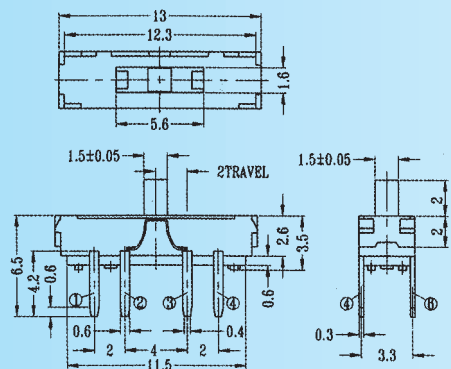
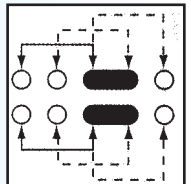

MS23D18

N NON-SHORTING

Rating: 0.3A 6V DC
 Travel: 2 mm
 Function: 2P3T
 Operating Force: 250 gf ± 150 gf
 Initial Contact Resistance: 70 mΩ MAX

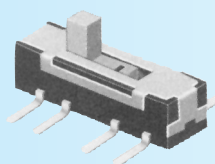
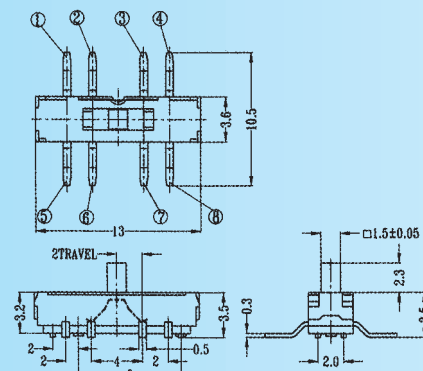
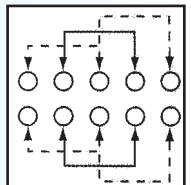

MS23D20

N NON-SHORTING

Rating: 0.3A 6V DC
 Travel: 2 mm
 Function: 2P3T
 Operating Force: 250 gf ± 150 gf
 Initial Contact Resistance: 70 mΩ MAX

